

# Residential New Construction Service Application (one to two living units)

**we energies**  
today, tomorrow, together.



**WE ENERGIES**  
700 S. KANE ST  
BURLINGTON, WI 53105  
FAX # 262-763-1077

## Site Information

Address/Fire Number: \_\_\_\_\_ Street: \_\_\_\_\_  
City/Town/Village: (Circle one and enter name) \_\_\_\_\_ State: \_\_\_\_\_ ZIP: \_\_\_\_\_  
County: \_\_\_\_\_ Subdivision: \_\_\_\_\_  
Lot #: \_\_\_\_\_ Block #: \_\_\_\_\_ Square Footage of Home: \_\_\_\_\_  
Second Address: (if duplex) \_\_\_\_\_

**Building Type:**  Frame Construction  Mobile Home  Factory Built Structure  Other (garage, outbuilding, etc.) \_\_\_\_\_  
**Current Construction Stage:**  No Start  Excavated  Capped Basement & Backfilled  Framed  Fully Enclosed  
 Finishing  
**Estimated Date of Delivery:** \_\_\_\_ / \_\_\_\_ / \_\_\_\_ (for mobile home or factory built structure)

## Home Owner Information

Name: \_\_\_\_\_ Additional Name: \_\_\_\_\_  
SS# or Driver's Lic #: \_\_\_\_\_ SS# or Driver's Lic #: \_\_\_\_\_  
Current Mailing Address: \_\_\_\_\_ Phone: (\_\_\_\_) (\_\_\_\_) \_\_\_\_\_  
City: \_\_\_\_\_ State: \_\_\_\_\_ ZIP: \_\_\_\_\_  
Phone: (\_\_\_\_) (\_\_\_\_) \_\_\_\_\_  
E-mail: \_\_\_\_\_  
Employer: \_\_\_\_\_  
(name) (location)

## Builder/Contractor Information

Company Name: \_\_\_\_\_ Phone: (\_\_\_\_) \_\_\_\_\_  
Contact Person: \_\_\_\_\_ Phone: (\_\_\_\_) \_\_\_\_\_ (work)  
Address: \_\_\_\_\_ Fax: (\_\_\_\_) \_\_\_\_\_ (alternate/mobile)  
City: \_\_\_\_\_ State: \_\_\_\_\_ ZIP: \_\_\_\_\_ E-mail: \_\_\_\_\_  
Send all correspondence to builder and homeowner:  Yes  No

## Billing Information (Please select one for each statement.)

Who should be billed for electric/gas installation?  Home Owner  Builder  
Who should be billed for electric/gas usage during construction?  Home Owner  Builder

If taxing, please provide the project address/location here: \_\_\_\_\_

## Electric Service Requirements (Complete this section only if electricity will be provided by We Energies.)

### Permanent Service:

### Temporary Service (if required):

Estimated date electric service will be needed: \_\_\_\_ / \_\_\_\_ / \_\_\_\_

Estimated date temporary service will be needed: \_\_\_\_ / \_\_\_\_ / \_\_\_\_

You will receive a letter and an *electric service site ready card* after your application has been processed. Please complete and return the *electric service site ready card* when your location is ready for service. Please review your *electric service site ready card* carefully to make sure your location is completely prepared for service installation. If the *electric service site ready card* is returned, but your site isn't ready for service, the wait time could be 45-60 days.

Service Size:  100 Amps  200 Amps  320 Amps  
 Other \_\_\_\_\_

Service Size:  100 Amps  200 Amps  Other: \_\_\_\_\_

Service Type:  Underground  Overhead

Service Type:  Underground  Overhead

Voltage:  120/240  Other: \_\_\_\_\_

### Electric Equipment Specifications:

	Quantity	Units
Electric Heating:	_____	_____ kW
Water Heater:	_____	_____ kW
Other (kiln, welder, etc):	_____	_____ kW or tons

	Quantity	Units
Heat Pump:	_____	_____ tons
Central Air Conditioning:	_____	_____ tons

### Electrical Contractor Information:

Electrical Contractor Name: \_\_\_\_\_ Contact Person: \_\_\_\_\_  
 Address: \_\_\_\_\_ Fax: ( ) \_\_\_\_\_  
 City: \_\_\_\_\_ State: \_\_\_\_\_ ZIP: \_\_\_\_\_ Phone: ( ) \_\_\_\_\_

## Natural Gas Service Requirements (Complete this section only if natural gas will be provided by We Energies.)

Estimated date gas service will be needed: \_\_\_\_ / \_\_\_\_ / \_\_\_\_

You will receive a letter and a *natural gas site ready card* after your application has been processed. Please complete and return the *natural gas site ready card* when your location is ready for service. Please review your *natural gas site ready card* carefully to make sure your location is completely prepared for service installation. If the *natural gas site ready card* is returned, but your site isn't ready for service, the wait time could be 45-60 days.

Number of inches basement wall will be exposed at the meter location after finished grade: \_\_\_\_\_ inches.

**Delivery Pressure:** (Check with heating dealer if unsure of pressure, because there is a charge if we have to change the pressure after installation.)

Standard (7" wc)  Elevated (2 psi)

### Gas Equipment Specifications:

	Quantity	BTU Input		Quantity	BTU Input
Furnace:	_____	_____	Dryer:	_____	_____
Boiler:	_____	_____	Grill:	_____	_____
Fireplace:	_____	_____	Standby Generator:	_____	_____
Water Heater:	_____	_____	Pool Heater:	_____	_____
Range:	_____	_____	Other (type) _____	_____	_____

### Natural Gas Contractor Information:

Heating Contractor Name: \_\_\_\_\_ Plumbing Contractor Name: \_\_\_\_\_  
 Address: \_\_\_\_\_ Address: \_\_\_\_\_  
 City: \_\_\_\_\_ State: \_\_\_\_\_ ZIP: \_\_\_\_\_ City: \_\_\_\_\_ State: \_\_\_\_\_ ZIP: \_\_\_\_\_  
 Phone: ( ) \_\_\_\_\_ Fax: ( ) \_\_\_\_\_ Phone: ( ) \_\_\_\_\_ Fax: ( ) \_\_\_\_\_

# Meter Location Requirements

Include a certified Plat of Survey with this application, and mark the following information on the Survey as shown in the example

- Your preferred gas meter location with a "G."
- The spot where your electrical contractor will be installing the electric meter socket with an "E."
- The measurement from the corner of the house to the desired electric and gas meter locations.
- Any above or below ground obstructions that are between the street and meter location. For these obstructions, check the appropriate box(es) below and mark them on your Plat of Survey or sketch.
- Choose your meter location(s) carefully because there is a charge for relocating your meter/service.
- There must be a 3-foot separation between the gas meter and sources of ignition and operable doors or windows.
- A 10-foot separation should be considered between the service regulator vent and direct vent gas appliance or air intake.
- The electric and gas meters should each be located on the exterior wall closest to the facilities from which they will be served to avoid additional installation charges.

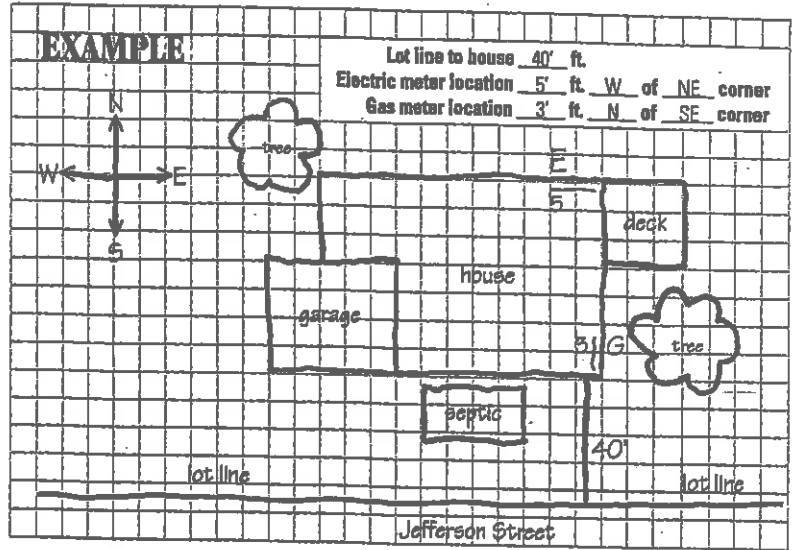

- |   |  |  |   |   |
|---|--|--|---|---|
| <input type="checkbox"/> Well           | <input type="checkbox"/> Underground Tank/Fuel Lines | <input type="checkbox"/> Steep Hill                    | <input type="checkbox"/> Trees            | <input type="checkbox"/> Yard Lighting      |
| <input type="checkbox"/> Septic         | <input type="checkbox"/> Drain Tiles/Downspouts      | <input type="checkbox"/> Customer-owned Cable          | <input type="checkbox"/> Sprinkler System | <input type="checkbox"/> Electric Dog Fence |
| <input type="checkbox"/> Retaining Wall | <input type="checkbox"/> Wetlands/Creeks             | <input type="checkbox"/> Other (please describe) _____ |   |   |

If a Plat of Survey does not exist, please sketch the building site in the space below, and mark all of the required information.

 Indicate North	<p style="text-align: center;">                     Lot line to house _____ ft.                      Electric meter location _____ ft. _____ of _____ corner                      Gas meter location _____ ft. _____ of _____ corner                 </p>
Lot Line	
_____ Street Name	

Don't forget to read and sign the back page.

## Excess Flow Valve (EFV)

As required by the US Department of Transportation (DOT), you are hereby being notified that an Excess Flow Valve that meets the minimum prescribed DOT performance standards is available for installation on your natural gas service line. Please review the enclosed brochure. (Applies only to single family homes.)

Please check the appropriate box:

- No, I would not like an Excess Flow Valve installed on my gas service line.
- Yes, I would like an Excess Flow Valve installed at the time my new gas service is installed. I agree to pay the installation cost and any future maintenance and/or replacement costs associated with the EFV on my gas service. I understand the cost of each repair could range from \$300 up to \$1,300 if excavation is required.

If I am a building contractor, I agree to take financial responsibility for payment of the EFV installation in the event a customer name is not available at the time the application is processed.

## Important Electric & Gas Service Information

- Electric/gas service will not be installed until site is within 4 inches of final grade and a 10-foot wide path is clear from property line to meter location. Gas service will not be installed until the home is framed.
- Call We Energies if you need help determining the proper meter location.
- Mark any areas of future expansion or potential porches, patios, decks, etc.
- Upon receipt of this application, We Energies will mail confirmation of this request along with additional information.
- We Energies will obtain all required permits prior to electric/gas service installation. Allow approximately thirty days to obtain permits and install electric/gas service.
- Applications received after November 15 and services installed between December 1 and March 15 are subject to winter construction charges.

## Private Underground Facilities

- We Energies, or a contractor working for the company, will be excavating or boring your property in order to install your electric/gas service line. To avoid damage to any private facilities (i.e. underground tanks, lighting, sewer, well, sprinkler, water, etc.) by We Energies (and/or its contractor), you are responsible for clearly and accurately identifying all private underground facilities with paint and/or stakes. A We Energies representative must be informed of all private underground facilities and proposed construction sites at the time of application.
- We Energies (and/or its contractor) will not be held responsible for any damage whatsoever to any private underground facility as a result of a lack of identification. The cost of any repairs to damaged private underground facilities and any additional expenses due to known or unknown private facilities will be your responsibility. If you need assistance in locating underground facilities, contact a locating contractor -- look in the yellow pages under Utilities-Underground, Cable, Pipe & Wire Locating Service. Please do *not* call Diggers Hotline, as they are unable to locate privately-owned facilities.
- Customer acknowledges that We Energies facilities will be attached to the Customer's building and that the attachment of We Energies facilities may affect certain Customer warranty rights. Customer agrees to indemnify, defend and hold We Energies, its directors, officers, employees and agents harmless from all judgements and claims, including attorney fees, relating in any way to Customer's loss of warranty rights as a result of any action taken on the part of We Energies to install facilities and equipment at Customer's property.

## Authorization

I certify that I own, or am the authorized representative of the owner of the property of the service address(es) indicated in this application, and that I have read and understood the above statements regarding locating and marking all private underground facilities. If the proposed installation cannot be completed to conform with requirements stated above, field changes may result in an increased cost to me.

Signature: \_\_\_\_\_ Date: \_\_\_\_\_

Printed Name: \_\_\_\_\_